



# New Directions in Higher Education: Where Do We Go From Here?

Legislative Advisory Committee Annual Meeting • The Westin Seattle • Seattle, WA • September 13-14, 2011

## AGENDA

### Tuesday, September 13

**8.00 – 8.45 am**

*Coldwater Loft  
Main Lobby Level*

#### **Networking Breakfast**

Enjoy a full breakfast with your legislative colleagues from the West.

**8.45 – 9.15 am**

*Vashon  
San Juan Level*

#### **Welcome, Introductions, and Overview of the Legislative Advisory Committee**

##### *Speakers:*

David Longanecker, president, *Western Interstate Commission for Higher Education*

Senator Dave Nething, *North Dakota*, WICHE Commissioner

**9.15 – 10.00 am**

*Vashon  
San Juan Level*

#### **What About Those Other Guys? A Look at Non-traditional Institutions**

For a variety of reasons, an increasing number of students are choosing to attend nontraditional institutions, such as “for-profits,” like the University of Phoenix (UOP), the ITT Institutes, and Kaplan University, as well as traditional, locally-owned trade schools and other highly regarded national institutions of long standing, like DeVry; online colleges that include Charter Oaks, Excelsior, and Rio Salado; and other unique and entrepreneurial institutions that have evolved in recent years, like Western Governors University, which is based entirely on competency-based learning. This session will focus on how these institutions came to define their mission and devise a business plan to accomplish that mission.

##### *Moderator:*

David Longanecker, president, *Western Interstate Commission for Higher Education*

##### *Speakers:*

Chris Bustamante, president, *Rio Salado College*

Alan Drimmer, provost & senior vice president academic affairs, *University of Phoenix*

Jean Floten, chancellor, *Western Governors University-Washington*

## Tuesday, September 13 (continued)

**10.00 – 10.30 am**

*Vashon*

*San Juan Level*

### **Facilitated Discussion: What About Those Other Guys? A Look at Non-traditional Institutions**

*Facilitator:*

David Longanecker, president, *Western Interstate Commission for Higher Education*

**10.30 – 10.45 am**

**Break**

**10.45 – 11.15 am**

*Vashon*

*San Juan Level*

### **Making Learning Count: Prior Learning Assessments**

Prior Learning Assessment (PLA) is a process that allows students to earn credit for proven college-level learning acquired outside the traditional classroom, including work, military, and community service. Recent research by the Council for Adult and Experiential Learning (CAEL) has shown that students who receive PLA credits have higher graduation rates and take a shorter time to complete a degree than students without such credits. To scale up PLA across the country, CAEL has launched *LearningCounts.org*, an online PLA service, with its collaborators, the American Council on Education (ACE) and the College Board. Learn from CAEL about how PLA is helping states, regions, and institutions increase degree completion for adult and nontraditional learners, and hear the latest on how LearningCounts.org is increasing access to PLA services.

*Moderator:*

Demarée Michelau, director of policy analysis, *Western Interstate Commission for Higher Education*

*Speakers:*

Mark Campbell, vice president, LearningCounts.org, *Council for Adult and Experiential Learning*

Amy Sherman, associate vice president of policy and strategic alliances, *Council for Adult and Experiential Learning*

**11.15 – 11.45 am**

*Vashon*

*San Juan Level*

### **Facilitated Discussion: Prior Learning Assessments**

*Facilitator:*

Demarée Michelau, director of policy analysis, *Western Interstate Commission for Higher Education*

## Tuesday, September 13 (continued)

11.45 am – 1.00 pm

*Coldwater Loft*

*Main Lobby Level*

### **LUNCH - Awakening the Giant: The Regulatory Environment of Distance Education**

Last year, the U.S. Department of Education announced rules requiring all higher education institutions participating in Title IV programs to be able to document compliance with state laws in all states where they offer distance or correspondence education. While these rules are not new, most institutions are not in compliance, which could result in a loss of eligibility to award federal student aid to that states' students. This session will brief participants on the current status of the regulatory environment of distance education.

*Speaker:*

David Longanecker, president, *Western Interstate Commission for Higher Education*

1.00 – 1.15 pm

**Break**

1.15 – 2.00 pm

*Vashon*

*San Juan Level*

### **Strengthening the Backbone of Higher Education: Preserving Accessibility and Affordability at Community Colleges in the West**

Community colleges face huge demands: students who enroll in them are more likely to be low-income, the first in their families to go to college, and members of underrepresented racial or ethnic groups. They serve many roles, including granting associate degrees, preparing students to transfer to four-year institutions, providing workforce development and skills training, and offering noncredit programs. To meet these competing demands, community college systems and institutions in the West, which enroll approximately 34 percent of the nation's public two-year students, are developing new models of serving a diverse student population. Three executive committee members of the Western Alliance for Community College Academic Leaders, a regional forum created by WICHE in 2010 to enable leaders from the two-year sector to share ideas and resources and collaborate on regional initiatives, will discuss key community college issues and legislative strategies to preserve the accessibility and affordability of this primary entryway to higher education.

*Moderator:*

David Longanecker, president, *Western Interstate Commission for Higher Education*

*Speakers:*

Jeff Fox, executive vice president and chief academic officer, *College of Southern Idaho*

Maria Harper-Marinick, executive vice chancellor and provost, *Maricopa Community Colleges*

Cam Preus, commissioner, *Oregon Department of Community Colleges and Workforce Development*, and WICHE Commissioner

## Tuesday, September 13 (continued)

2.00 – 2.30 pm

Vashon

San Juan Level

### Facilitated Discussion: Preserving Accessibility and Affordability at Community Colleges in the West

*Facilitator:*

David Longanecker, president, *Western Interstate Commission for Higher Education*

2.30 – 2.45 pm

### Break

2.45 – 3.15 pm

Vashon

San Juan Level

### Blaming it on the Equipment: Evolving Higher Education Governance in the West

Still reeling from the Great Recession, state legislatures across the country looked for new ways to trim state budgets and improve outcomes this past legislative session. One of the strategies that several states adopted was to change the governance structure of their higher education systems. Learn about how these structures are changing, what motivated these changes, and what state legislators hope for in the future as a result of these developments.

*Moderator:*

Demarée Michelau, director of policy analysis, *Western Interstate Commission for Higher Education*

*Speakers:*

Senator Jeanne Kohl-Welles, *Washington*, WICHE Commissioner

Representative Michael Dembrow, *Oregon*

Senator Carol Liu, *California*

3.15 – 4.00 pm

Vashon

San Juan Level

### Facilitated Discussion: Evolving Higher Education Governance

*Facilitator:*

Demarée Michelau, director of policy analysis, *Western Interstate Commission for Higher Education*

6.00 pm

### Optional Group Dinner

Please meet in the hotel lobby for an evening at a nearby restaurant.

## Wednesday, September 14

8.00 – 8.30 am

Coldwater Loft

Main Lobby Level

### Networking Breakfast

Enjoy a full breakfast with your legislative colleagues from the West.

## Wednesday, September 14 (continued)

8.30 – 9.00 am

Vashon

San Juan Level

### **Tapping Mature Talent: Responding to a Changing Workforce**

In 2012, workers over 55 years of age will comprise 1 in 5 members of the U.S. workforce. The economy is causing many people now to work beyond traditional retirement age so these numbers will likely increase. These adults bring skills and experience critical to maintaining a competitive workforce, but many older adults face barriers when trying to find jobs. Funded by the U.S. Department of Labor, 10 sites throughout the country are developing and implementing innovative strategies that will lead to employment for this population. They are working collaboratively with partners to make changes in the public workforce system, education, and business that will address the specific needs of mature workers. In this session, learn about promising state and regional practices and policies to promote an engaged and productive mature workforce.

*Moderator:*

Demarée Michelau, director of policy analysis, *Western Interstate Commission for Higher Education*

*Speaker:*

Amy Sherman, associate vice president of policy and strategic alliances, *Council for Adult and Experiential Learning*

9.00 – 9.30 am

Vashon

San Juan Level

### **Facilitated Discussion: Responding to a Changing Workforce**

*Facilitator:*

Demarée Michelau, director of policy analysis, *Western Interstate Commission for Higher Education*

9.30 – 10.00 am

Vashon

San Juan Level

### **The Common Core State Standards: Coming to a Higher Education Institution Near You**

The Common Core State Standards in English/Language Arts and Mathematics have been adopted by most states, yet many in higher education are just beginning to understand their implications. These standards are increasingly becoming a central part of postsecondary access and preparation discussions, even in states that have not adopted them. This session will provide an introduction to the new standards, an overview of how they may impact student access and success in college, a discussion of the Smarter Balanced Assessment Consortium, and the legislative role in these changes.

*Moderator:*

Demarée Michelau, director of policy analysis, *Western Interstate Commission for Higher Education*

*Speakers:*

Ryan Reyna, program director, education division, *National Governors Association*  
Joe Willhoft, executive director, *Smarter Balanced Assessment Consortium*

## Wednesday, September 14 (continued)

**10.00 – 10.30 am**

*Vashon*

*San Juan Level*

### **Facilitated Discussion: The Common Core State Standards**

*Facilitator:*

Demarée Michelau, director of policy analysis, *Western Interstate Commission for Higher Education*

**10.30 – 10.45 am**

### **Break and Hotel Check-Out**

**10.45 am – 11.00 am**

*Vashon*

*San Juan Level*

### **Higher Education in the West: Where Do We Go From Here?**

This meeting has been about change in higher education and new ways of doing business. With all these different efforts occurring simultaneously and all during a period of economic recovery, higher education has an opportunity to take a giant leap forward. With creativity and political will, positive change is possible, but what are the next steps? Where does higher education, particularly in the West, go from here?

*Speaker:*

David Longanecker, president, *Western Interstate Commission for Higher Education*

**11.00 – 11.45 am**

*Vashon*

*San Juan Level*

### **Facilitated Discussion: Where Do We Go From Here?**

*Facilitator:*

David Longanecker, president, *Western Interstate Commission for Higher Education*

**11:45 am – 12.00 pm**

*Vashon*

*San Juan Level*

### **Closing Remarks**

*Speakers:*

David Longanecker, president, *Western Interstate Commission for Higher Education*

Senator Dave Nething, *North Dakota*, WICHE Commissioner

**12.15 pm**

### **Optional Group Lunch**

Please meet in the hotel lobby for an optional group lunch at a nearby restaurant.

## 2011 LEGISLATIVE ADVISORY COMMITTEE MEMBERS

### ALASKA

Representative Paul Seaton [APPOINTED 2009]  
Senator Bettye Davis [APPOINTED 2009]

### ARIZONA

Representative Steve Court [APPOINTED 2011]  
Senator David Schapira [APPOINTED 2009]

### CALIFORNIA

Senator Carol Liu [APPOINTED 2011]  
Assemblymember Ricardo Lara [APPOINTED 2011]

### COLORADO

Representative Tom Massey [APPOINTED 2008]  
Senator John Morse [APPOINTED 2008]

### HAWAII

Representative Scott Nishimoto [APPOINTED 2011]  
Senator Jill Tokuda [APPOINTED 2009]

### IDAHO

Representative Mack Shirley [APPOINTED 2008]  
Vacancy

### MONTANA

Senator Bob Lake [APPOINTED 2009]  
Senator Kim Gillan [APPOINTED 2010]  
Vacancy

### NEVADA

Assemblywoman Debbie Smith [APPOINTED 2011]  
Senator Joseph Hardy [APPOINTED 2011]  
Senator Steven Horsford [APPOINTED 2009]

### NEW MEXICO

Senator Tim Keller [APPOINTED 2009]  
Vacancy

### NORTH DAKOTA

Representative Bob Martinson [APPOINTED 2008]  
Senator Ray Holmberg [APPOINTED 2008]  
Senator Dave Nething [APPOINTED 1999]

### OREGON

Representative Michael Dembrow [APPOINTED 2010]  
Senator Richard Devlin [APPOINTED 2010]

### SOUTH DAKOTA

Representative Jim Putnam [APPOINTED 2008]  
Senator Jeff Haverly [APPOINTED 2009]

### UTAH

Representative Mel Brown [APPOINTED 2010]  
Senator Peter Knudson [APPOINTED 2006]  
Senator John Valentine [APPOINTED 2009]

### WASHINGTON

Representative Phyllis Gutierrez Kenney [APPOINTED 2005]  
Senator Jeanne Kohl-Welles [APPOINTED 2005]  
Senator Derek Kilmer [APPOINTED 2009]

### WYOMING

Representative Samuel Krone [APPOINTED 2011]  
Representative Robert McKim [APPOINTED 2010]  
Vacancy

## The Westin Seattle

1900 5th Avenue • Seattle, Washington 98101 • United States  
Phone (206) 728-1000 • Fax (206) 728-2259

---

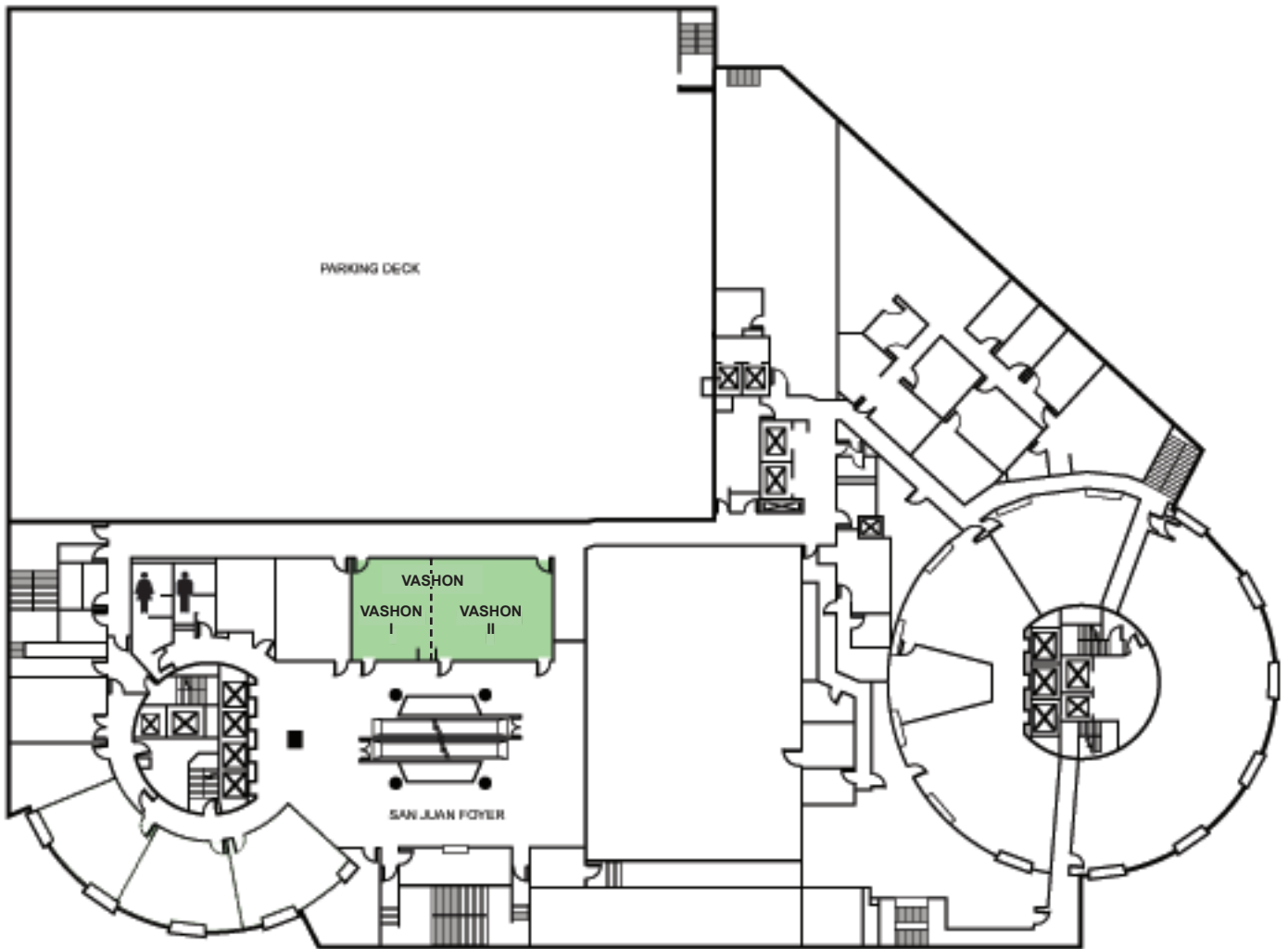

**SAN JUAN LEVEL**